

Acad Ref: I:\TNS Schemes\T001-General\321 - Great Stoke Roundabout\5 - Docs & Dwg\Drawings\T001-321-008 Temporary Footway Diversion Routes.dwg - Plotted by ns3 on Nov 13, 2019 - 11:38am

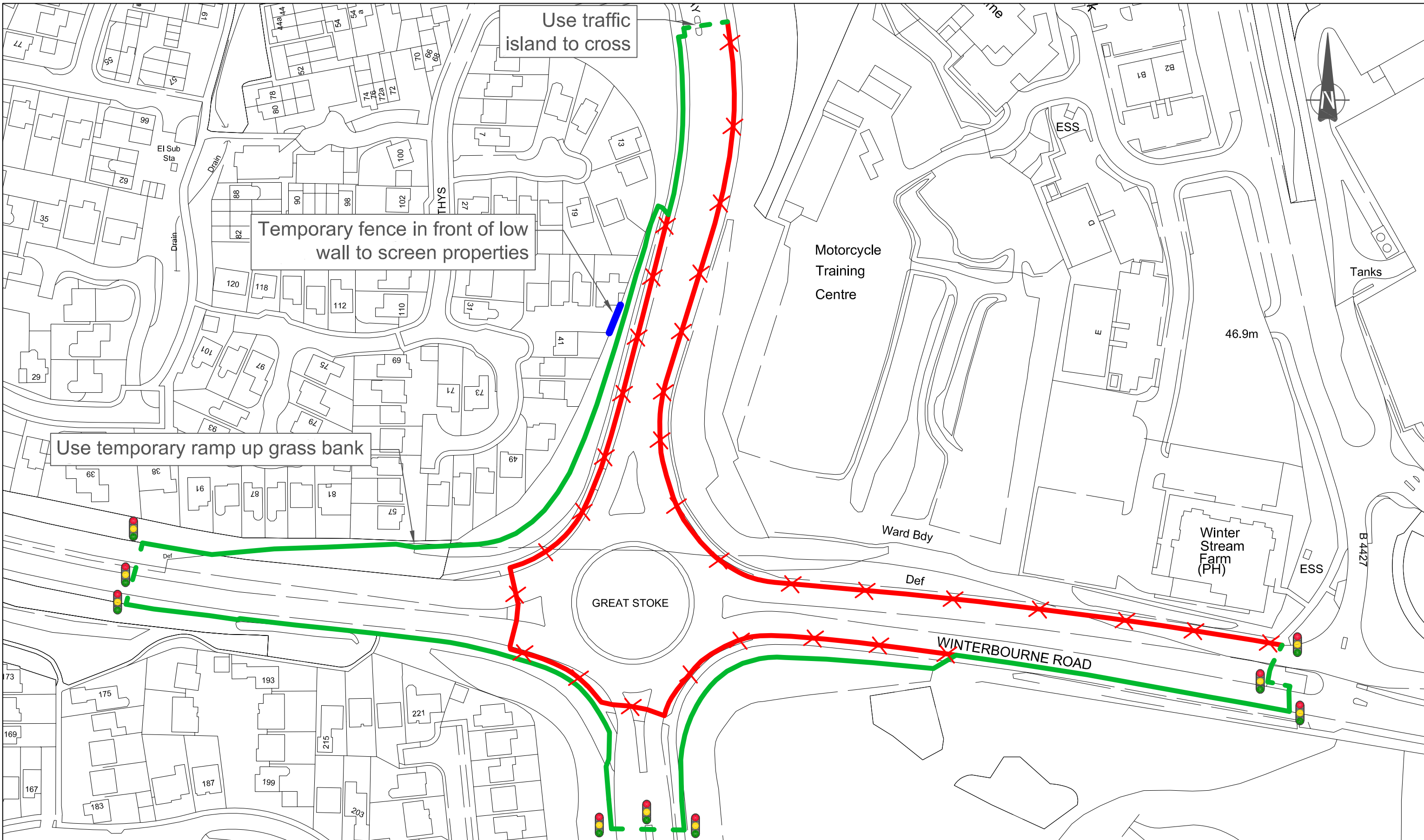

ORDNANCE SURVEY

© Crown copyright and database rights 2019 Ordnance Survey 100023410. This map has been provided for this scheme consultation and must not be used for any other purpose. Only one paper copy may be made for your own use.

Rev	Description	Drawn	App'd	Date

Key:

- Closed Footway/Cycleway
- Temporary Footway/Cycleway Diversion
- Crossing With Traffic Lights

South Gloucestershire Council
 DEPARTMENT OF ENVIRONMENT AND COMMUNITY SERVICES

DIRECTOR
 Steve Evans

STREETCARE TRANSPORT & WASTE
 PO Box 1954
 Bristol, BS37 0DD
 Telephone: 01454 868 000
 Email: TransportServices@southglos.gov.uk

Project		Great Stoke Roundabout Improvements			
Title		Temporary Footway/cycleway Diversion Routes			
Scale @ A3	1:1250	Drawn	DB/NS	Checked	RL
Date	Oct.19	Date	Nov 19	Date	Nov 19
Dwg No.	T001 - 321 - 008	Parish	Schemes	Number	Rev.